

BILAG 9.1 – AIA, ADK

OVERSIGT

BILAG 9.1 – AIA, ADK	1
9.1.1 AIA, ADK	2
9.1.2 AIA, Skilte	3
9.1.3 AIA, Skilte	4
9.1.4 AIA, Brandtryk	5
9.1.5 AIA, ADK, Skilte, Brandtryk	6
9.1.6 AIA, ADK	7
9.1.7 ADK Beslag type 1	8
9.1.8 ADK Beslag type 2	9
9.1.9 AIA, kip drejefunktion	1
9.1.10 Indsigtsafskærmning	2
9.1.11 Indsigtsafskærmning	3
9.1.12 Indsigtsafskærmning	4
9.1.13 Indsigtsafskærmning	5

9.1.1 AIA, ADK

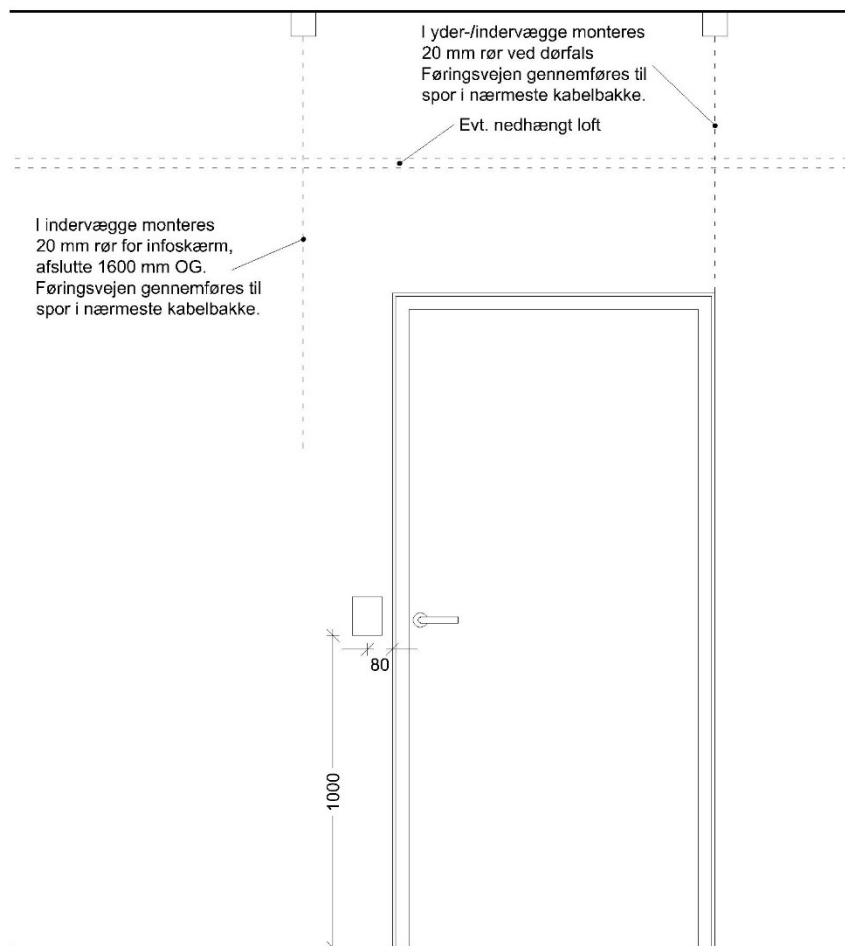

Placering Kortlæser

Kortlæser monteres altid på beslag type 2,
beslag pulverlakeres i samme farve som væg.

9.1.2 AIA, SKILTE

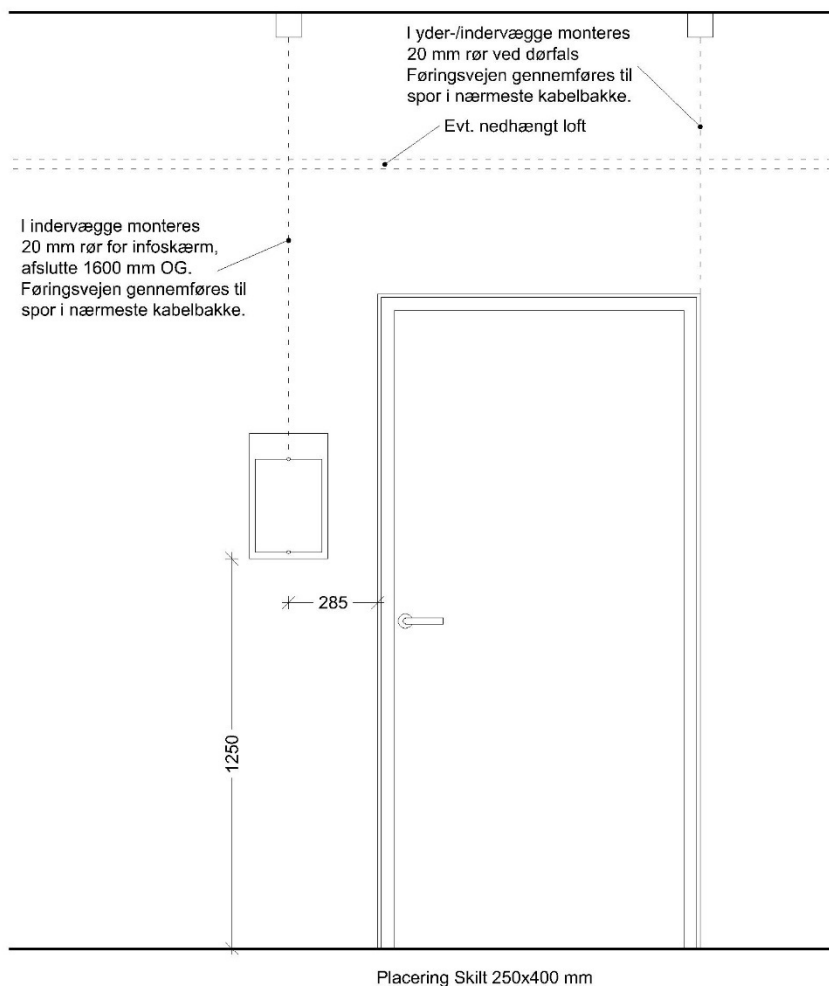

9.1.3 AIA, SKILTE

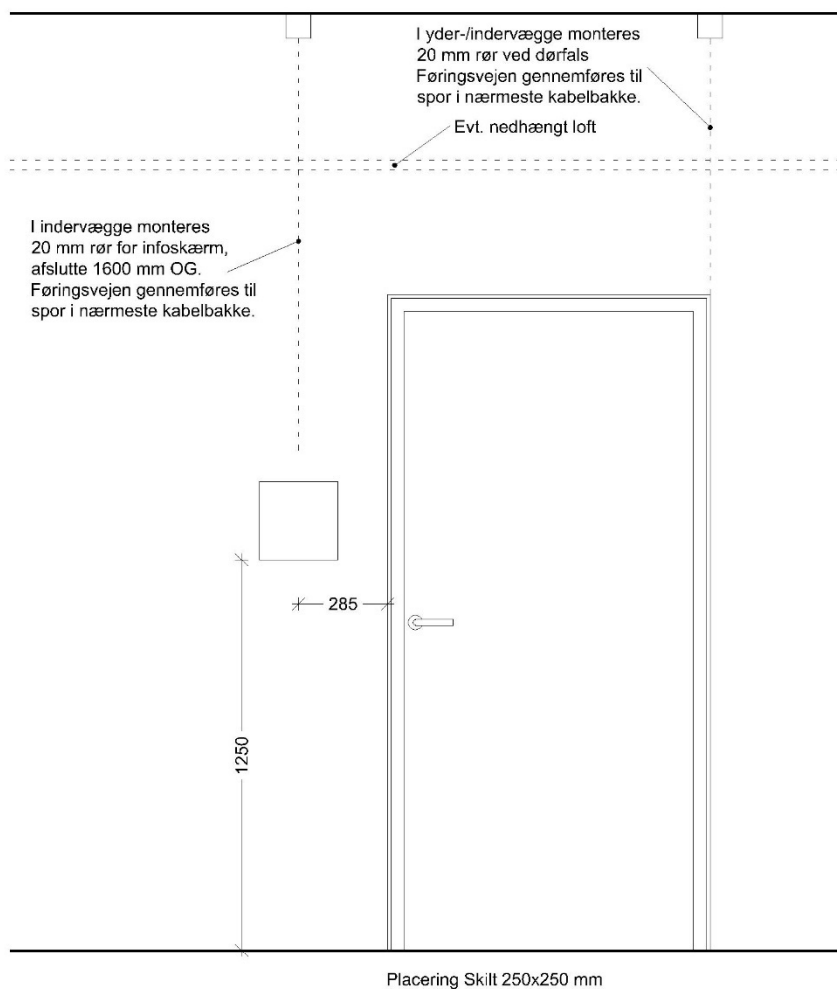

9.1.4 AIA, BRANDTRYK

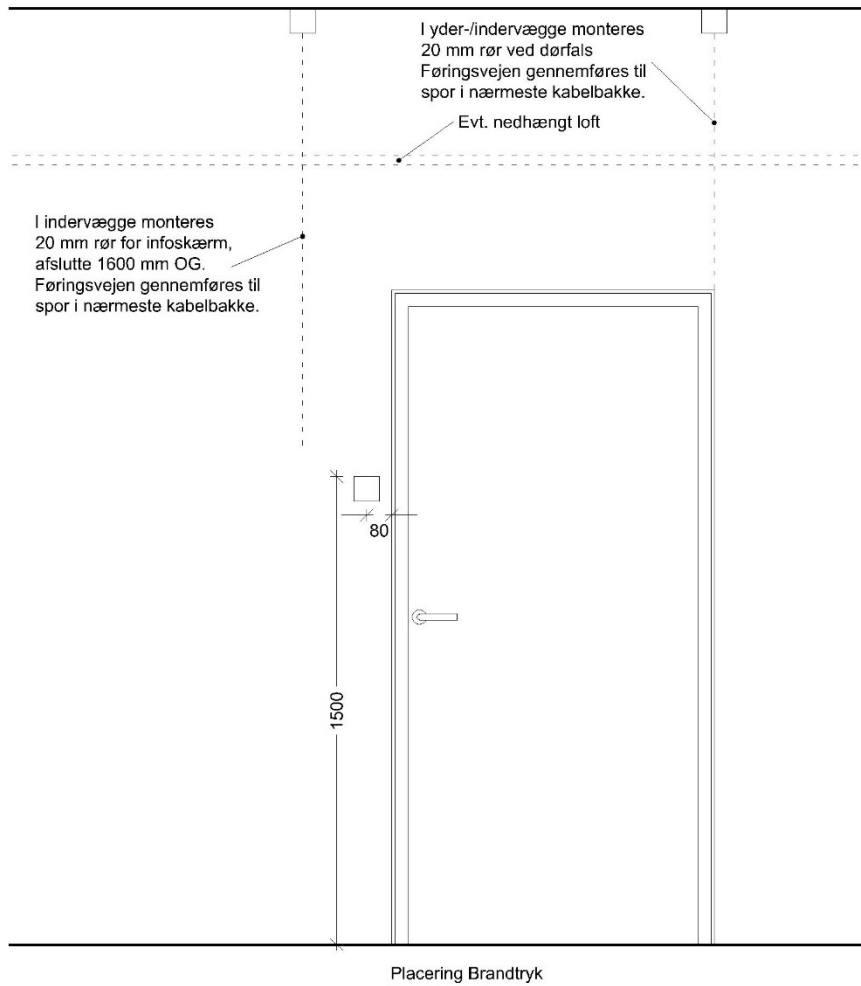

9.1.5 AIA, ADK, SKILTE, BRANDTRYK

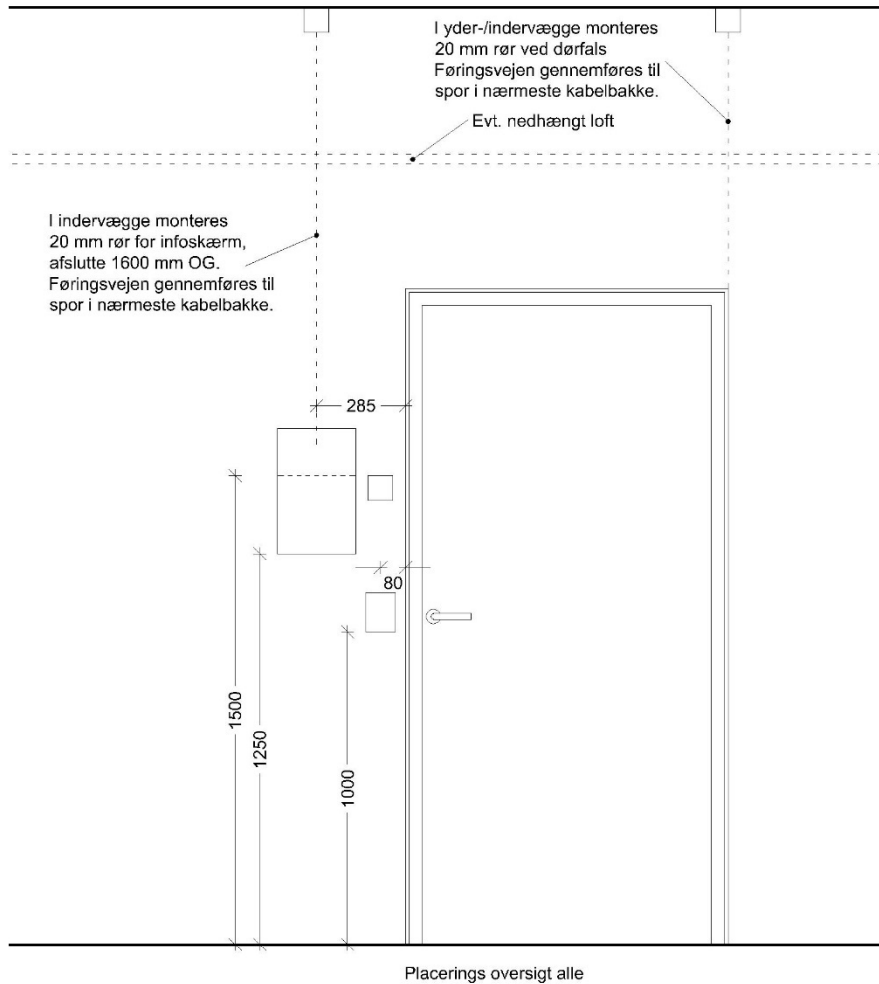

9.1.6 AIA, ADK

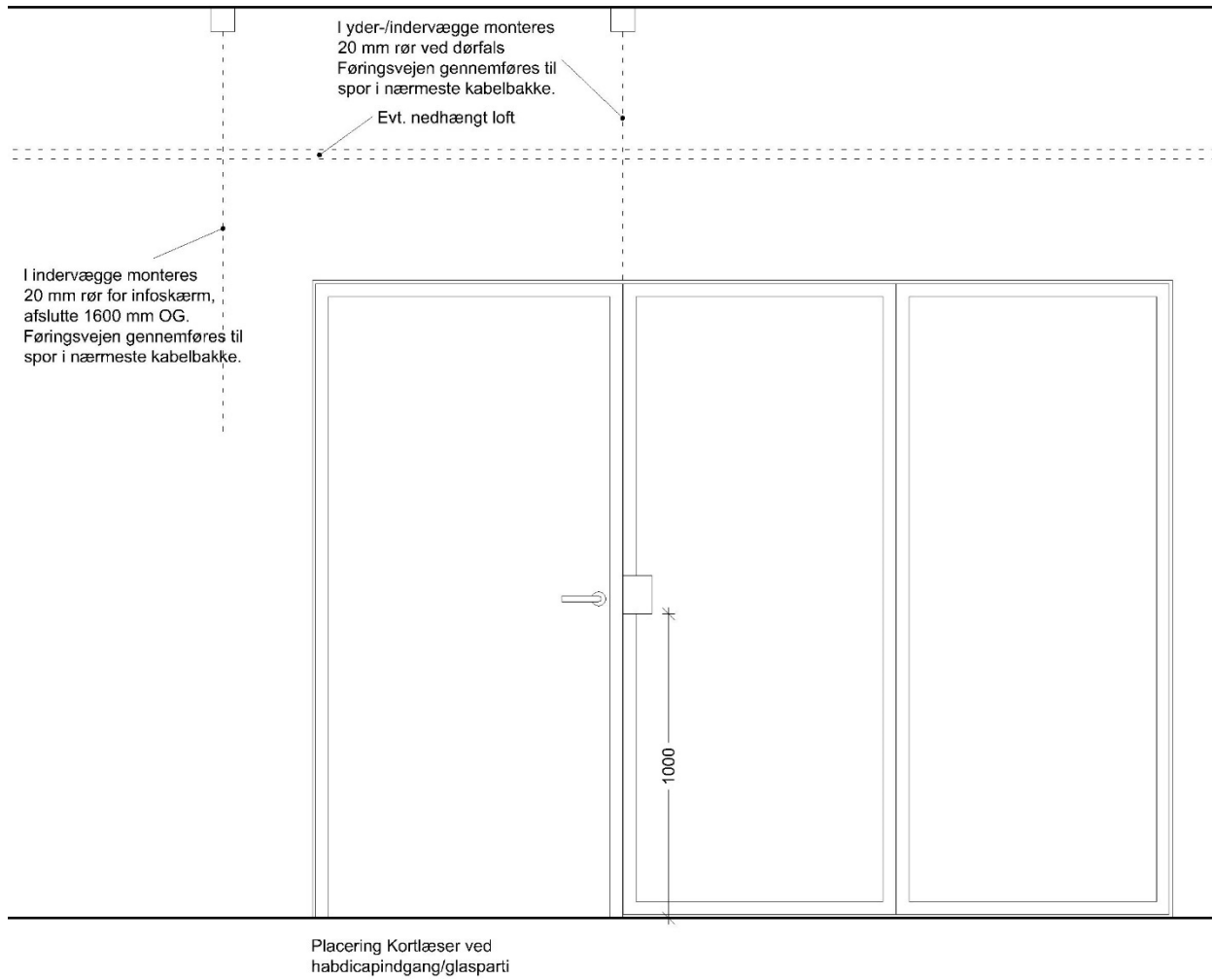

9.1.7 ADK BESLAG TYPE 1

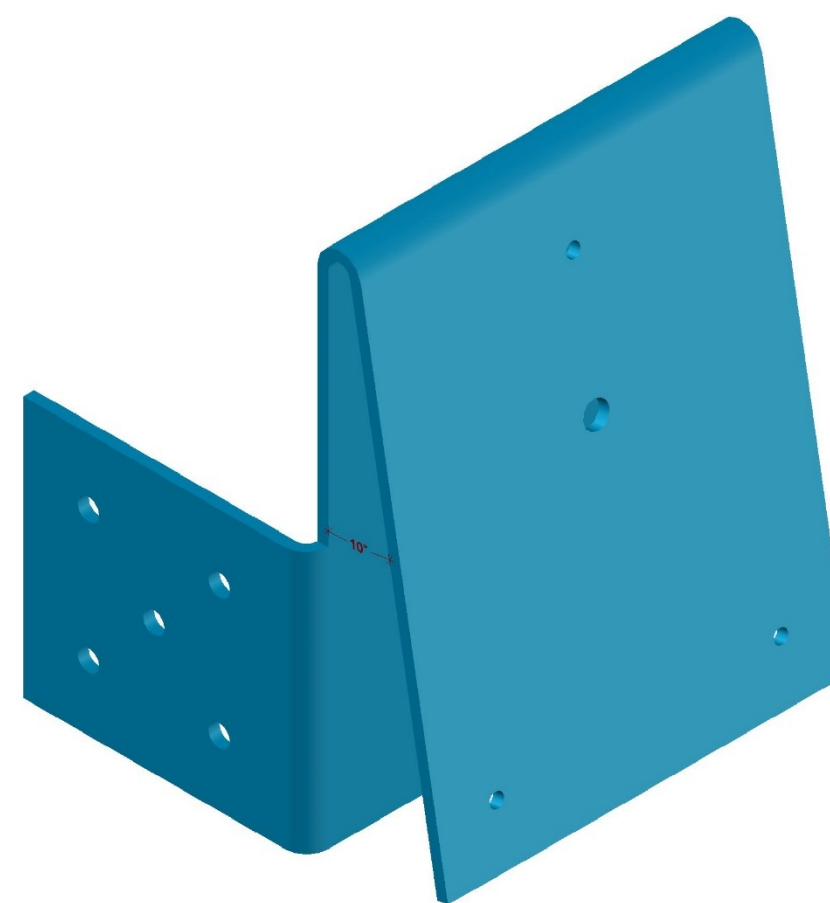
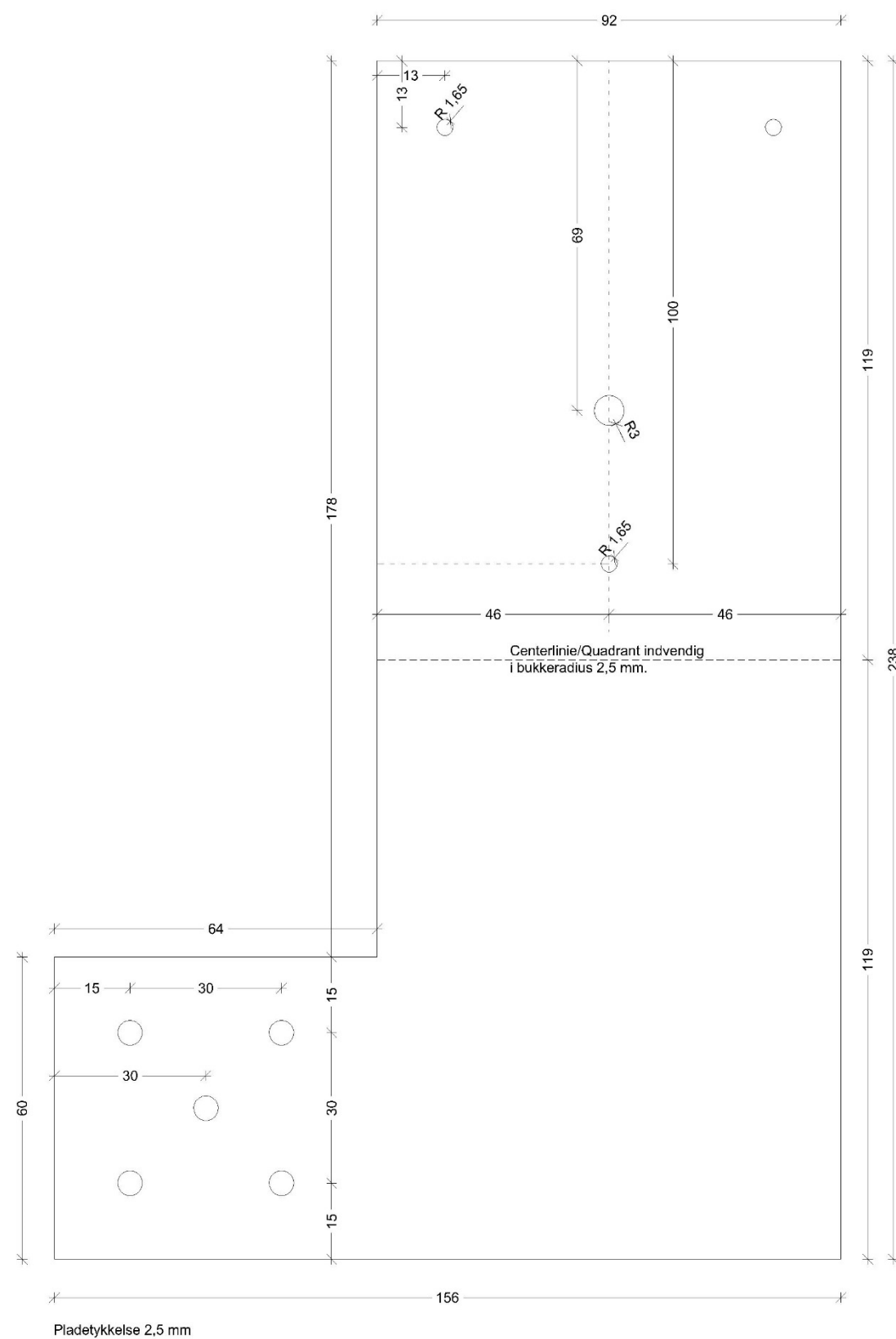

Type 1



9.1.8 ADK BESLAG TYPE 2

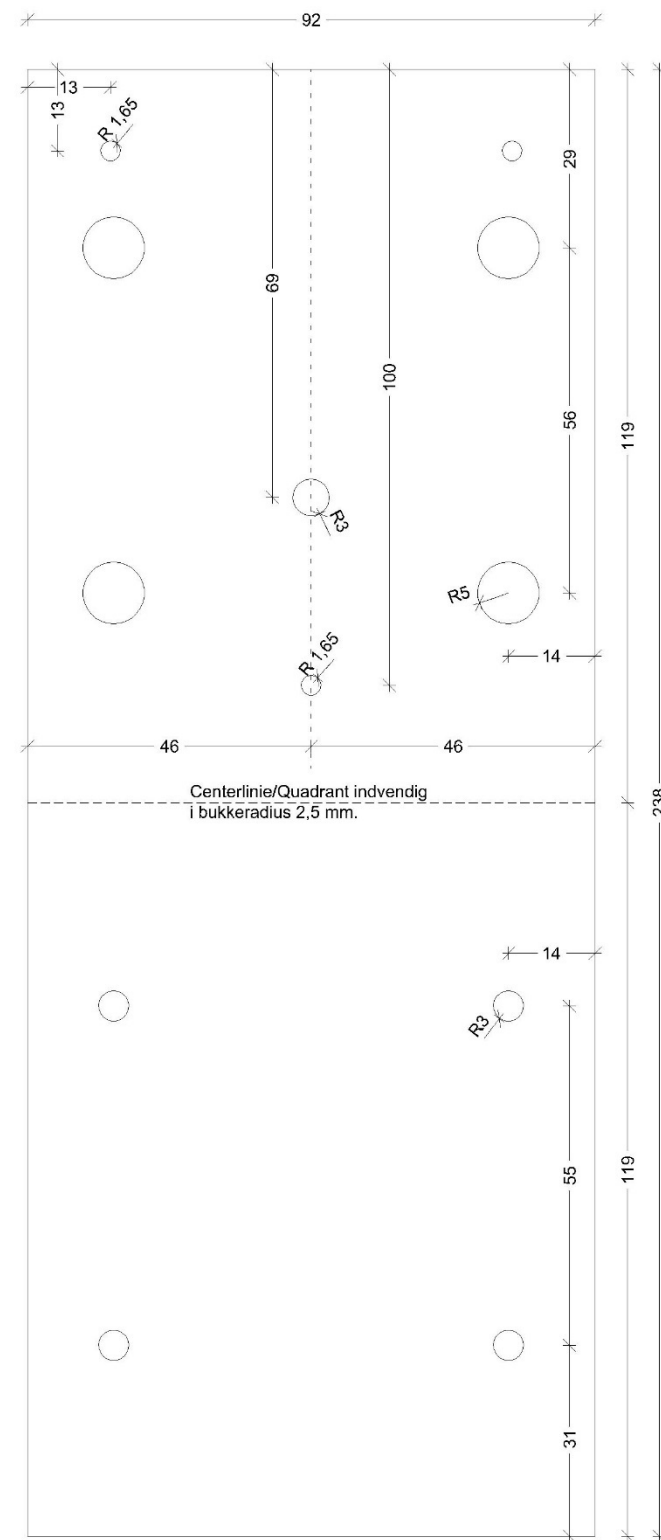

Pladetykkelse 2,5 mm

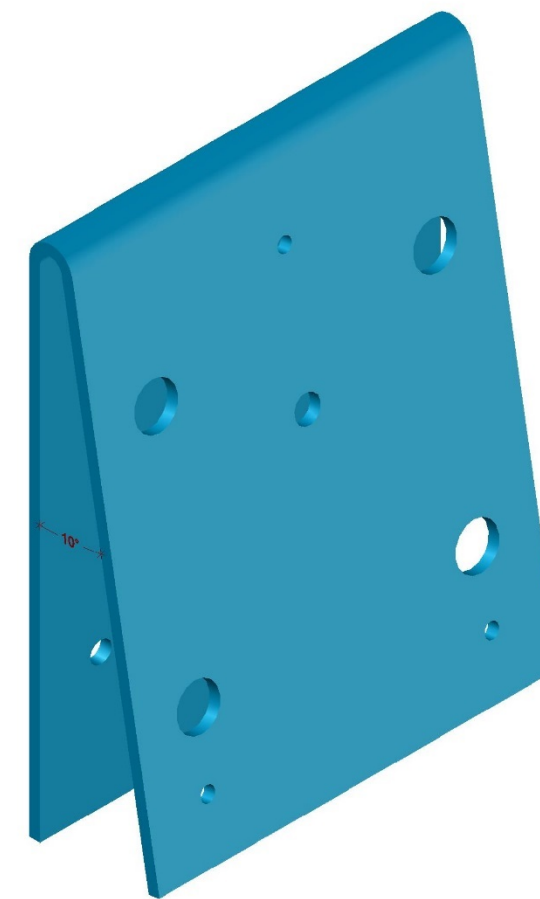

Type 2



CAMPUS SERVICE
AALBORG UNIVERSITET

Dato: 06.12.2016

9.1.9 AIA, KIP DREJEFUNKTION

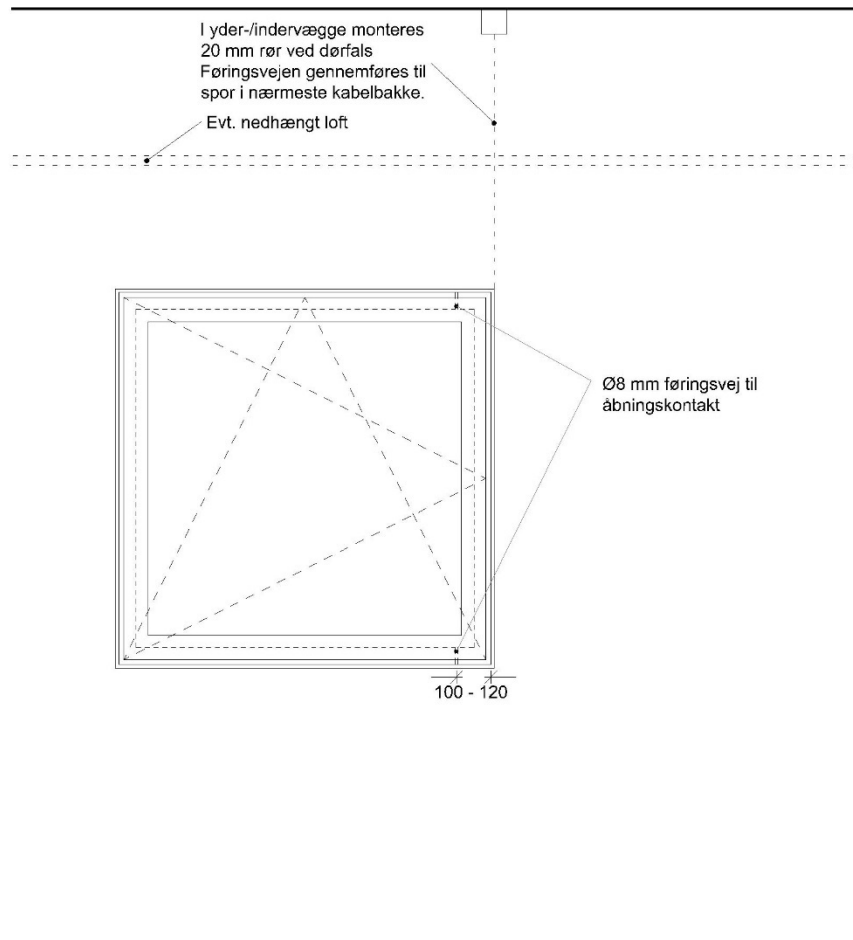

9.1.10 INDSIGTSAFSKÆRMNING

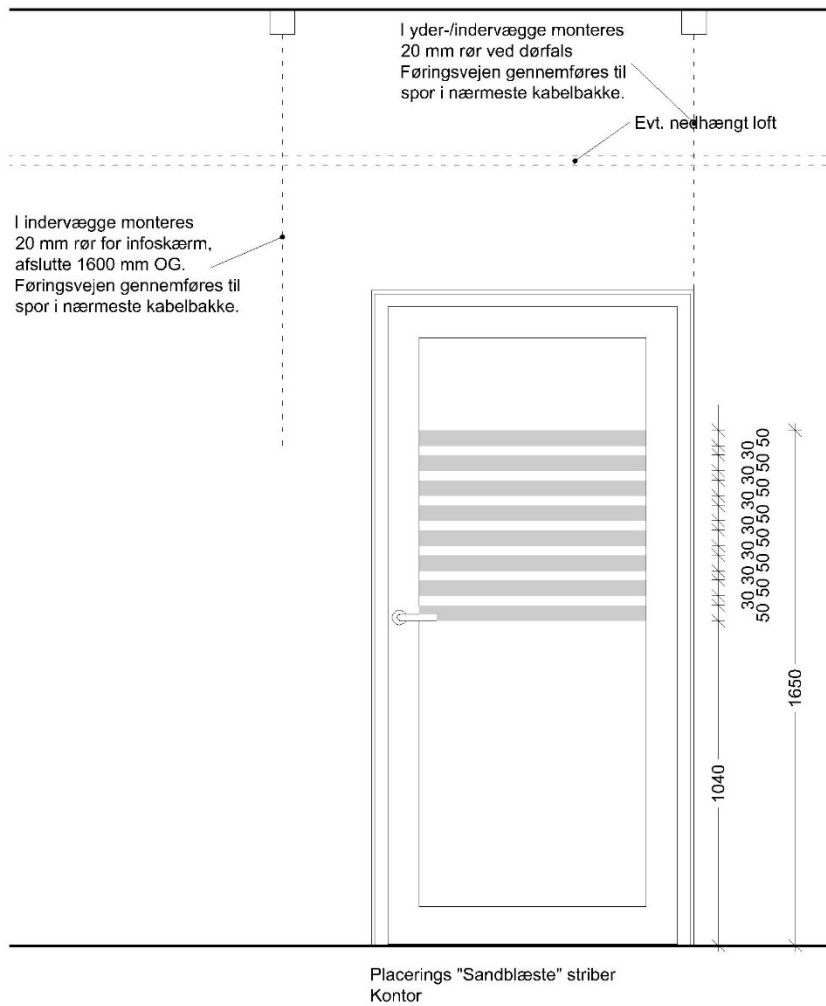

9.1.11 INDSIGTSAFSKÆRMNING

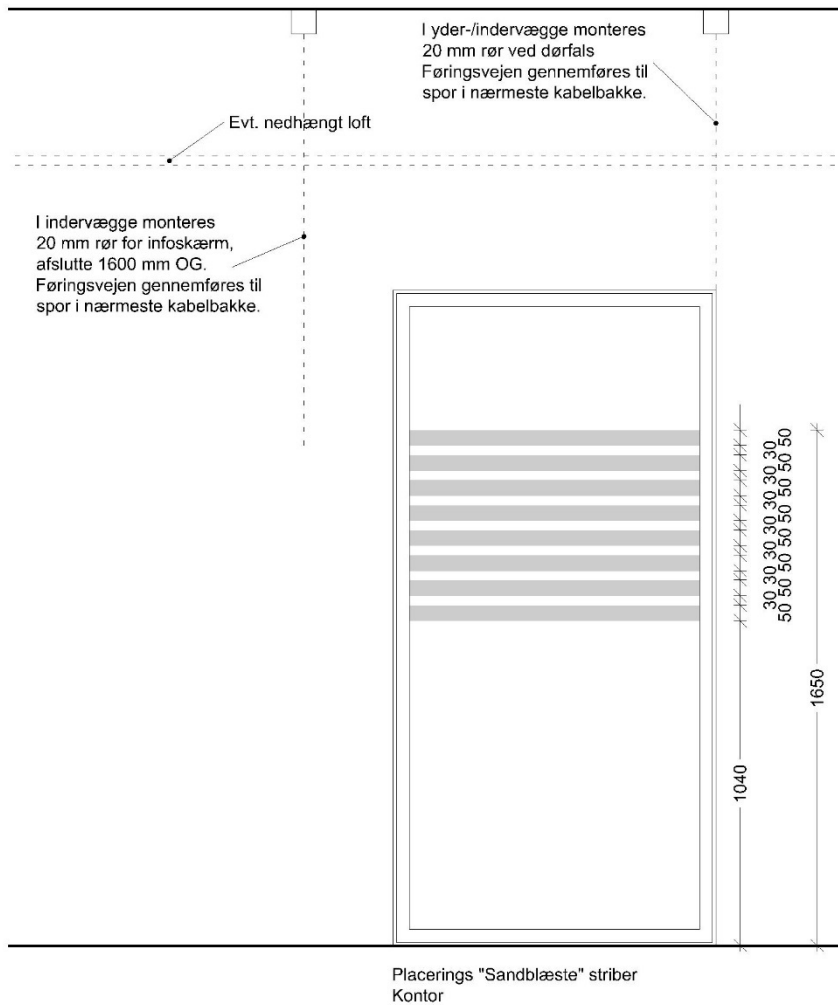

9.1.12 INDSIGTSAFSKÆRMNING

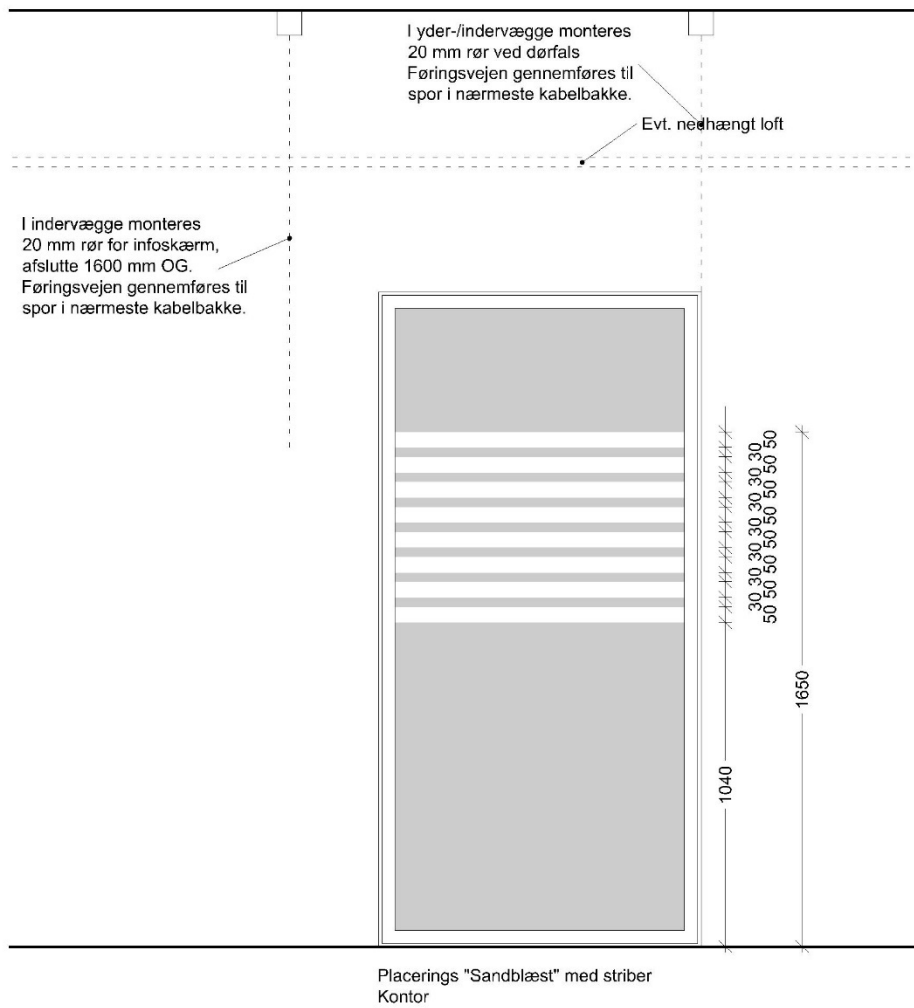

9.1.13 INDSIGTSAFSKÆRMNING

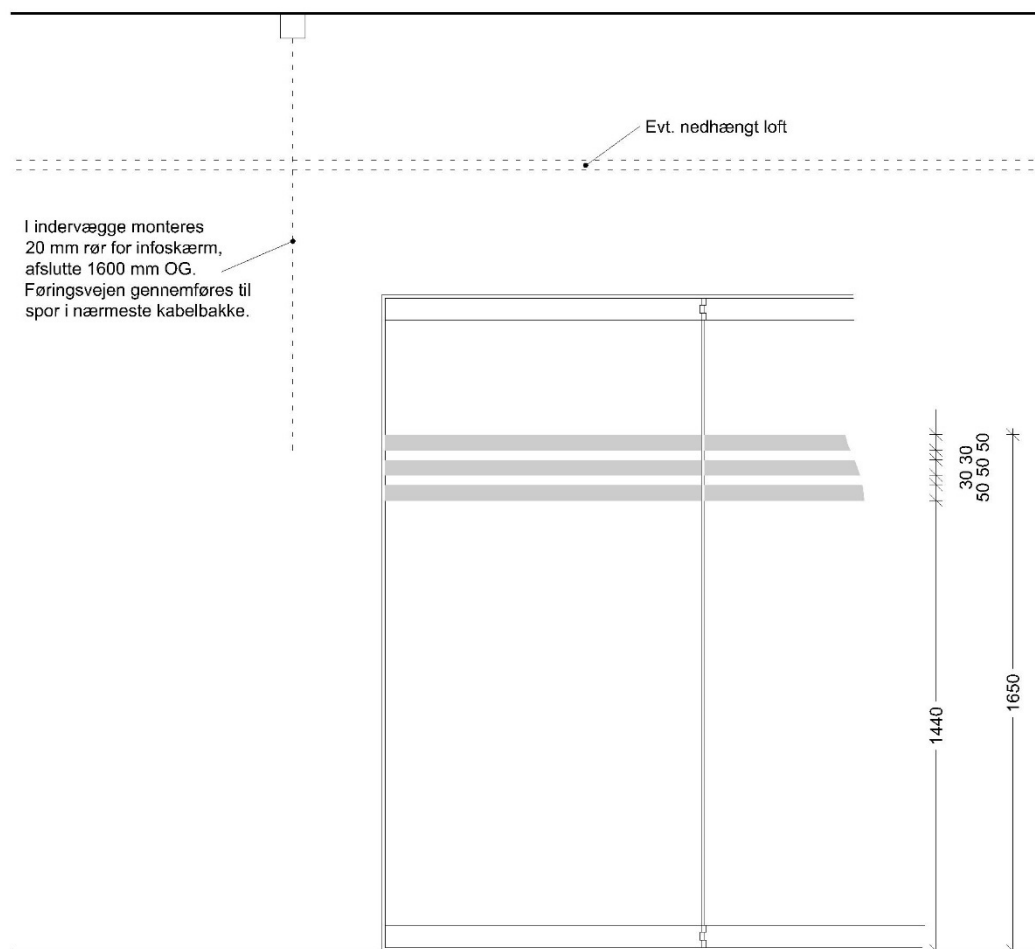

I indervægge monteres 20 mm rør for infoskærm, afslutte 1600 mm OG. Føringsvejen gennemføres til spor i nærmeste kabelbakke.

Evt. nedhængt loft

1440
30
30
50
50
1650

Placerings "Sandblæste" striber
Studiemiljø - Fællesrum - MM.